

● = Component of the 14-46-0087 5263-59 Service Maintenance Kit

**NOTE:**  
Item 78 (45-88-1060) Spacer, has two alternate components included in the Maintenance Kit (14-46-0085) that can be used based on the fit with the assembly. Those alternate components are:  
1. 45-88-1168 Spacer  
2. 45-88-1345 Spacer

FIG.	PART NO.	DESCRIPTION OF PART	NO. REQ.
15	02-50-0040	Needle Bearing	(1)
16	34-40-0215	Gearcase Cover	(1)
17	34-40-0225	Seal Ring	(1)
18	02-50-2185	Needle Bearing	(1)
19	02-04-0310	Ball Bearing	(1)
20	28-14-0085	Gearcase	(1)
30	32-75-0075	Spindle Sleeve	(1)
31	02-04-0683	Steel Ball	(3)
32	45-08-0075	Striker	(1)
33	45-08-0080	Ram	(1)
34	32-75-0095	Spindle Sleeve Assembly	(1)
35	44-62-0020	Piston Assembly	(1)
36	40-50-0855	Spring	(1)
37	42-70-0020	Clutch Disc	(1)
38	02-02-1300	5mm Steel Ball	(3)
39	32-75-0125	Gear Wheel	(1)
40	34-40-0245	O-Ring	(2)
41	40-50-8045	Pressure Spring	(1)
42	42-36-1755	Support Plate	(1)
43	44-90-0075	Holding Ring	(1)
44	02-02-0185	Steel Ball	(1)
45	42-96-0030	Sleeve	(1)
47	34-40-0265	O-Ring	(1)
48	02-50-0045	Needle Bearing	(1)
49	32-75-0130	Gear	(1)
50	02-50-0055	Needle Bearing	(1)
51	42-70-0025	Clutch Ring	(1)
52	40-50-0865	Spring	(1)
53	44-60-0280	Pin	(1)
54	45-88-0965	Washer	(1)
55	43-16-0025	Eccentric Shaft	(1)
56	30-20-0020	Bearing Pin Clamp	(1)
59	43-46-0172	Depth Gauge	(1)
61	49-15-5300	Side Handle	(1)
64	42-52-5262	Dust Cap	(1)
66	44-90-0375	External Snap Ring	(1)
68	44-90-0085	Retaining Ring	(1)

34	30	31	32	33	36	37	38	39	70	71
	72	73	75	76	77	78	79	85	86	88

FIG.	PART NO.	DESCRIPTION OF PART	NO. REQ.
70	34-40-0285	● O-Ring	(1)
71	44-90-0185	● Retaining Ring	(1)
72	44-90-0195	● Retaining Ring	(1)
73	44-90-0205	● Retaining Ring	(3)
74	34-40-1510	● O-Ring	(1)
75	34-40-0305	● O-Ring	(1)
76	42-76-0095	● Thrust Collar	(2)
77	45-88-0985	● Flange Washer	(1)
78	45-88-1060	● Spacer	(1)
79	45-88-1115	● Stop Washer	(1)
80	45-88-1145	● Bearing Washer	(1)
81	45-88-1155	● Disc Washer	(1)
82	42-36-0175	● Backing Flange	(1)
83	05-74-0480	● M5 x 25 Screw	(2)
84	34-40-0320	● Seal Ring	(1)
85	34-40-0325	● O-Ring	(1)
86	45-88-0975	Washer	(1)
	14-46-0087	Maintenance Kit	(1)

**LUBRICATION NOTES:** Type 'Q2' Grease  
No. 49-08-5345, 1.5 oz. / 45g tube

Type 'P' Grease  
No. 49-08-5350, 3.5 oz. / 100g tube

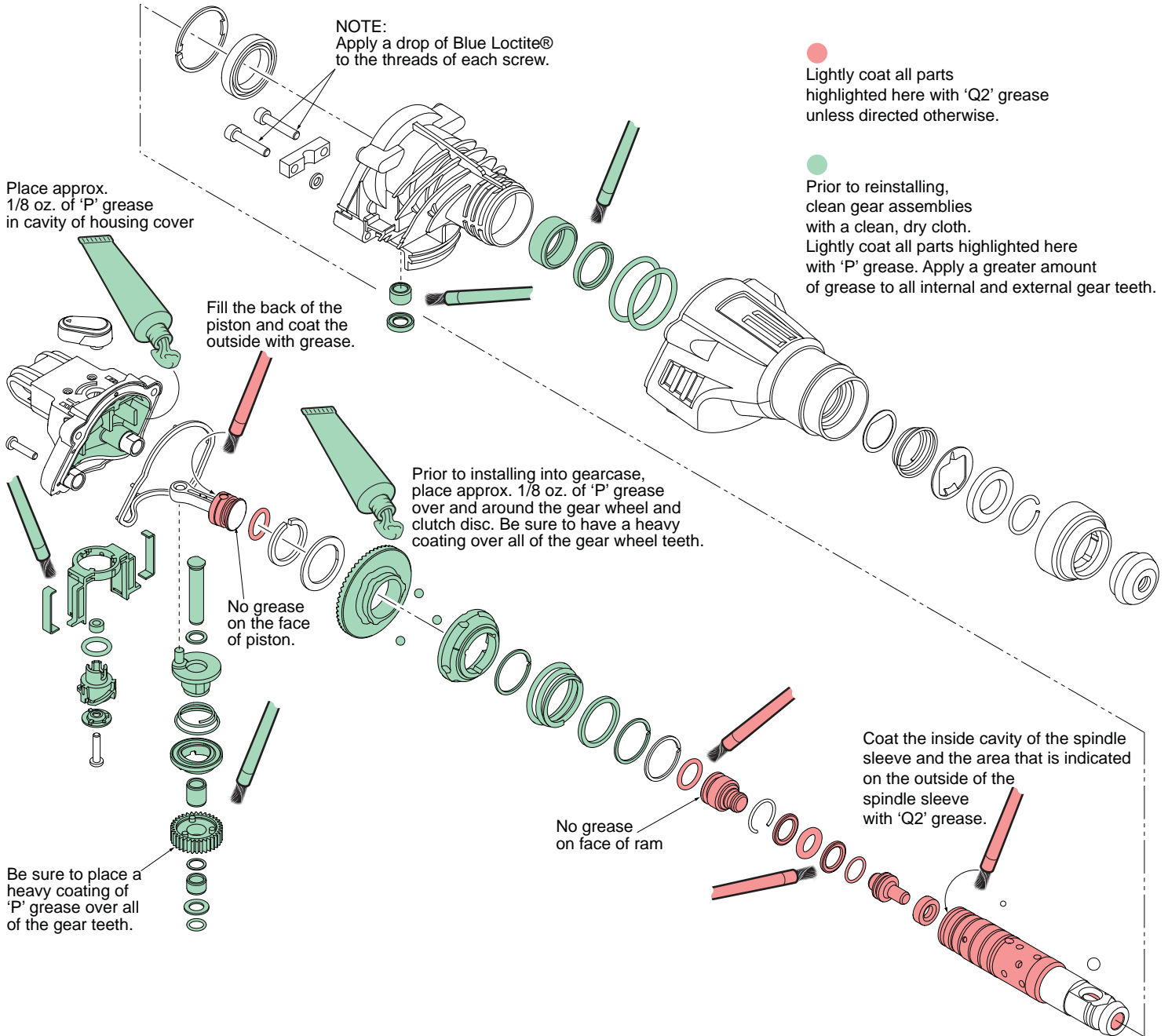

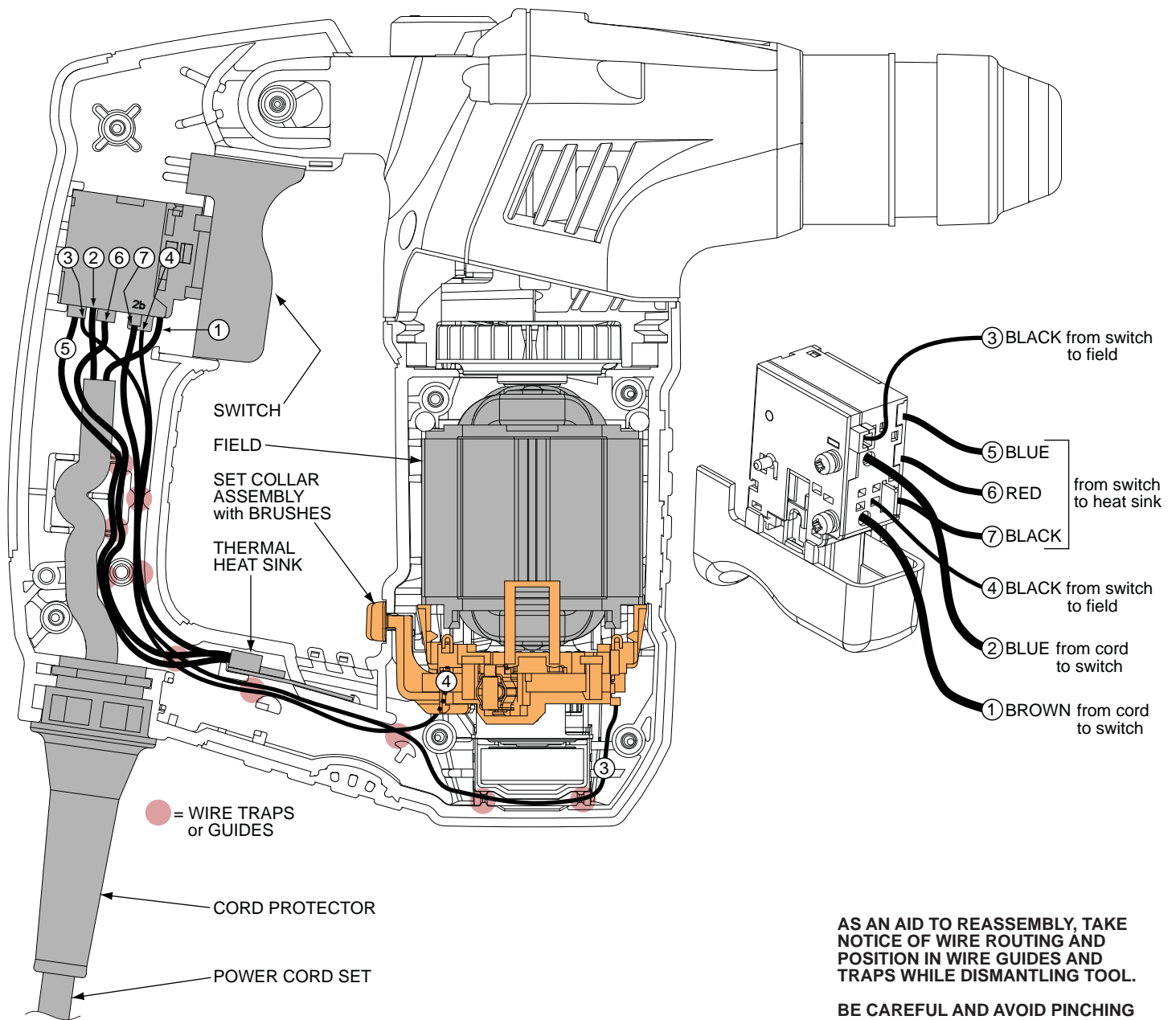

AS AN AID TO REASSEMBLY, TAKE NOTICE OF WIRE ROUTING AND POSITION IN WIRE GUIDES AND TRAPS WHILE DISMANTLING TOOL.

BE CAREFUL AND AVOID PINCHING WIRES BETWEEN HANDLE HALVES WHEN ASSEMBLING.

### WIRING SPECIFICATIONS

Wire No.	Wire Color	Origin or Gauge	Length	Terminals, Connectors and 1 or 2 End Wire Preparation
1	Brown	22-64-5261	-----	Component of cord set. Connect to switch as shown.
2	Blue	22-64-5261	-----	Component of cord set. Connect to switch as shown.
3	Black	23-94-0335	-----	Leadwire assembly. Connect to switch and front right position of the field as shown.
4	Black	23-94-0330	-----	Leadwire assembly. Connect to switch and rear left position of the field as shown.
5	Blue	23-66-5261	-----	Component of the switch assembly. Wired between the switch and the thermal heat sink.
6	Red	23-66-5261	-----	Component of the switch assembly. Wired between the switch and the thermal heat sink.
7	Black	23-66-5261	-----	Component of the switch assembly. Wired between the switch and the thermal heat sink.