

Assembly Instructions

Open Stand (Stock No. 609004)

for use with Model 22-44 Plus Drum Sander

1. Assemble the legs (A, Figure 1) to the outside of the short rails (B, Figure 1) using carriage bolts and lock nuts. Finger tighten only at this point.
2. Assemble the long rail (C, Figure 1) to the inside of the legs and on top of the short rails. Finger tighten only at this point.
3. Turn the stand upside down and attach the shelf using carriage bolts and lock nuts. Finger tighten only at this point.
4. Install the leveling feet, or optional casters, in the hole at the bottom of the legs. There should be one hex nut on either side of the flange on the leg to adjust the foot.
5. Turn the stand right side up and tighten all of the hardware.
6. Attach the 22-44 Plus Drum Sander to the stand with four 3/8"-16 x 3/4" hex cap screws and four 3/8" flat washers. These fasteners come with the sander.

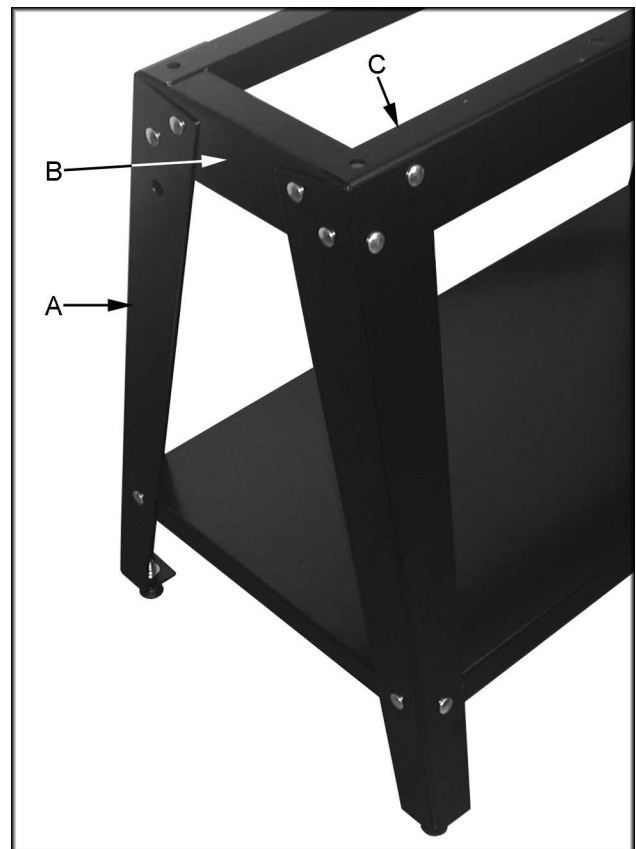

Fig. 1

WMH TOOL GROUP

2420 Vantage Drive
Elgin, Illinois 60123
Ph.: 800-274-6848
www.wmhtoolgroup.com

Part No. M-609004
Revision C 4/06
Copyright © WMH Tool Group

Parts Breakdown for the 22-44 Open Stand

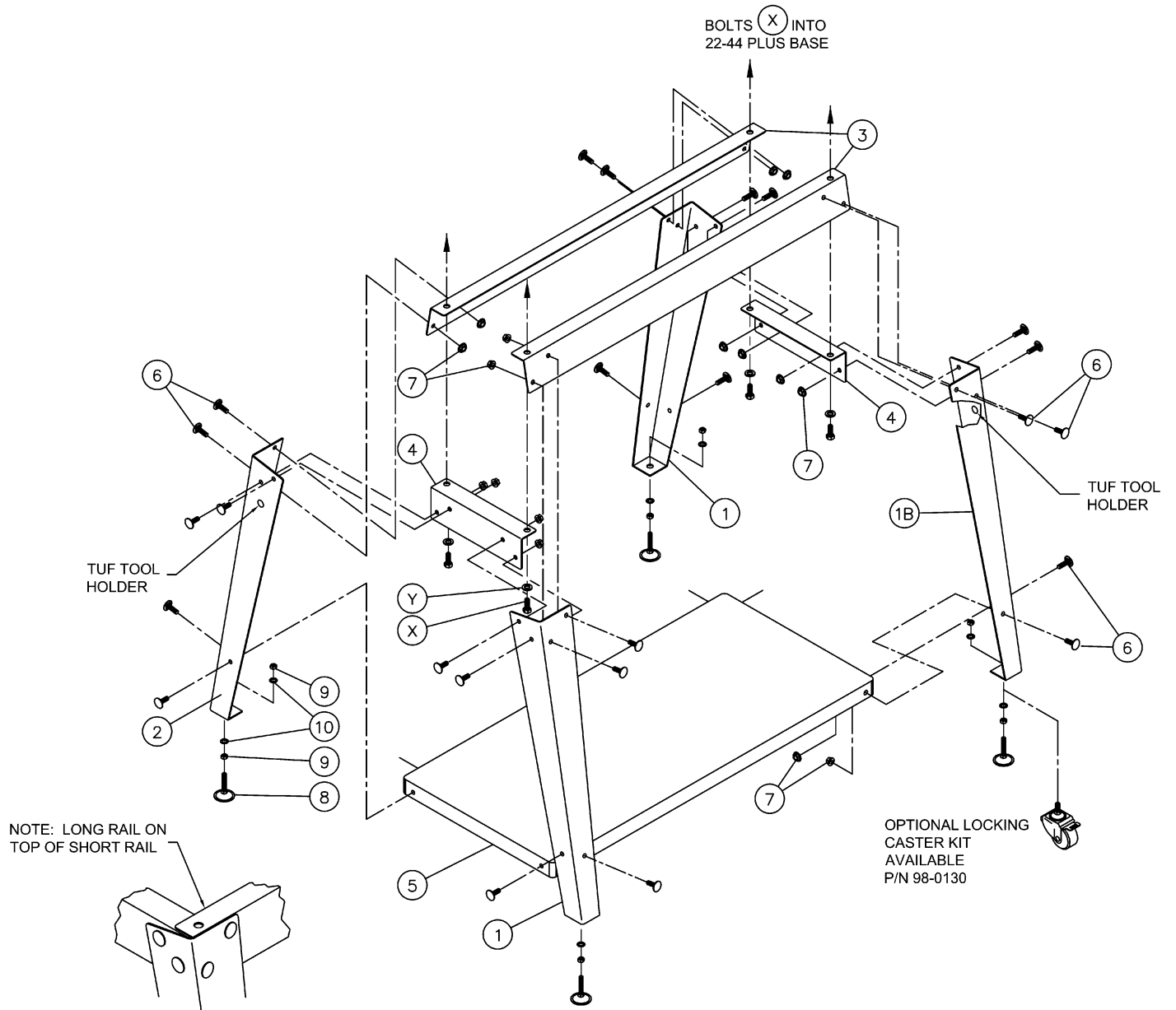

Index No.	Part No.	Description	Size	Qty.
1.....	40-4040.....	Leg, Left		2
2.....	40-4041.....	Leg, Right (with TUF tool holder).....		2
3.....	2244PLUS-303.....	Rail, Long		2
4.....	2244PLUS-304.....	Rail, Short.....		2
5.....	2244PLUS-305.....	Shelf		1
6.....	10-1206.....	Carriage Bolt.....	5/16-18x5/8"	24
7.....	12-0207.....	Nut, Flanged Lock.....	5/16"	24
8.....	20-0655.....	Leveling Foot.....		4
9.....	12-0005.....	Hex Nut	3/8"-16	8
10.....	11-9103.....	Flat Washer	3/8	8