

INSTALL 26 TO WIRE HARNESS  
ASSY FROM 27 AFTER  
25 AFTER WIRE HARNESS  
IS INSERTED THROUGH 19

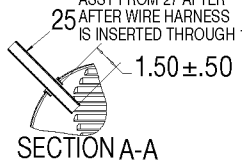

1 TORQUE 20-25 IN-LBS

24 SCREW ON HAND TIGHT

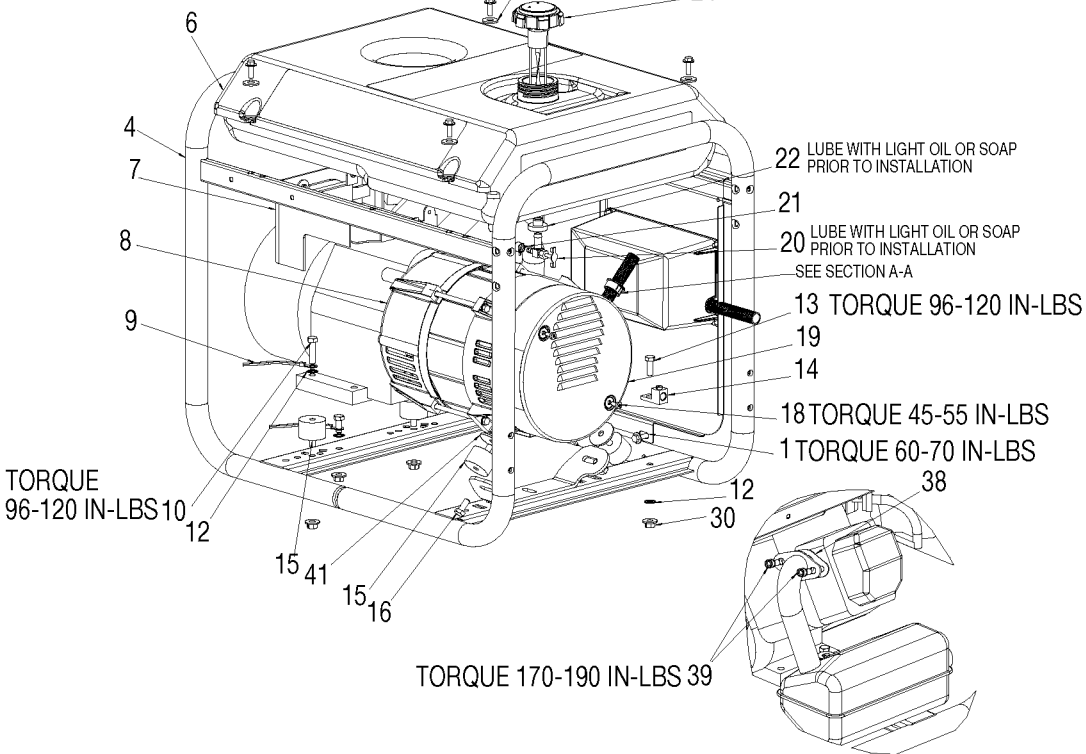

TORQUE  
96-120 IN-LBS 10

22 LUBE WITH LIGHT OIL OR SOAP  
PRIOR TO INSTALLATION

20 LUBE WITH LIGHT OIL OR SOAP  
PRIOR TO INSTALLATION  
SEE SECTION A-A

13 TORQUE 96-120 IN-LBS

18 TORQUE 45-55 IN-LBS

1 TORQUE 60-70 IN-LBS

TORQUE 170-190 IN-LBS 39