

800

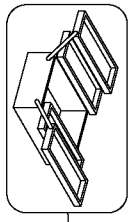

836

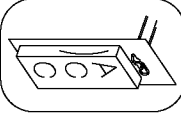

856

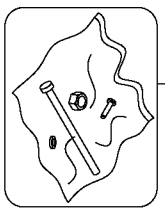

846

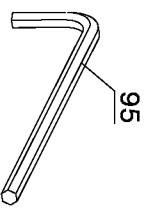

95

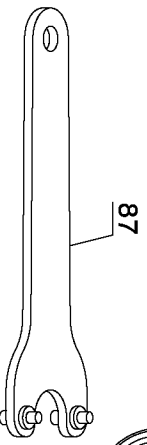

87

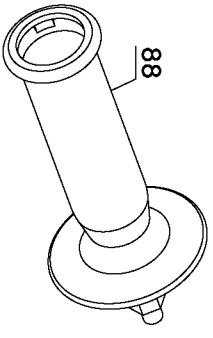

88

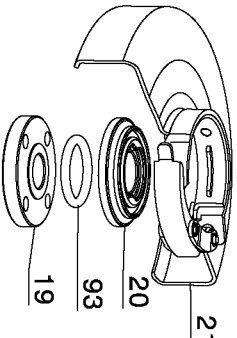

19

20

21



92

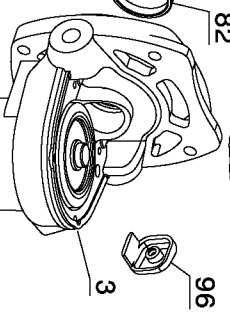

3

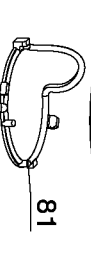

96

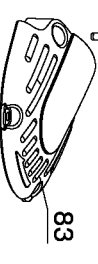

81



83

84

## Parts List for D28114-B2 Type 1

Item Number	Part Number	Description	Qty Required
1	N065827	ARMATURE ASSEMBLY	1
2	632180-01	FIELD CASE	1
3	629447-04	GEAR CASE ASSY.	1
4	330065-31	SCREW	9
5	648743-00	ARM	2
5	648743-00	ARM	2
6	623592-00	FELT SEAL	4
8	640491-03	BRUSH	2
9	636760-00	BRUSH SPRING	2
10	623591-00	CAP	2
11	593685-00	SCREW	2
12	633016-02S	HANDLE ASSY	1
13	945614-02	SWITCH	1
14	N055787	SEPARATOR	1
15	623619-01S	PADDLE ASSY.	1
16	628398-00	CORD CLAMP	1
17	330019-03	SCREW	2
18	330005-01	PROTECTOR,CORD	1
19	636226-00	NUT	1
19	622613-02	KNURLED NUT	1
20	633257-00SV	BACKING FLANGE	1
21	397661-02	GUARD ASSY.	1
22	625415-00	PLUG	1
22	625323-00	LOCK-ON BUTTON	1
23	562210-00	SPRING	1
24	N072342	PWR SPLY CORD	1
26	623593-00	TERMINAL	2

COPYRIGHT© 2005. All Rights Reserved.

Parts list, pricing, and availability subject to change. Please visit [www.dewaltservicenet.com](http://www.dewaltservicenet.com) for current parts information.

## Parts List for D28114-B2 Type 1

Item Number	Part Number	Description	Qty Required
28	N069661	NAMEPLATE	1
29	628885-00	ID LABEL	1
30	626891-00	WARNING LABEL	1
31	N032631	MODULE	1
33	631028-01	TERMINAL	1
35	633391-00	SEAL	1
69	152684-00	TERMINAL	2
70	604484-00	NUT	1
71	627465-00	PINION	1
72	330003-03	BEARING,BALL	1
73	623617-00	FELT SEAL	1
74	623580-00	BRG. RETAINER	1
75	623613-00	SLINGER	1
76	605040-02	BALL BEARING	1
77	641823-00	BEARING CUP	1
78	627125-04	FIELD	1
79	623572-00	FAN BAFFLE	1
80	330065-25	SCREW	4
81	632513-00	GASKET	1
82	611492-00	SLEEVE,RUBBER	1
83	627313-00	GEAR CASE COVER	1
84	385676-01	SCREW	4
85	631609-02	SCREW	1
87	N079326	WRENCH	1
88	614796-00	SIDE HANDLE	1
90	634599-00	TERMINAL	1
92	633045-00	O-RING	1

COPYRIGHT© 2005. All Rights Reserved.

Parts list, pricing, and availability subject to change. Please visit [www.dewaltservicenet.com](http://www.dewaltservicenet.com) for current parts information.

## Parts List for D28114-B2 Type 1

Item Number	Part Number	Description	Qty Required
93	633043-00	O-RING	1
96	623570-00	SPINDLE LOCK BUTTON	1
800	583534-00	GREASE	1
800	429954-01	GREASE,1 LB.	1
800	429954-00	GREASE, 7LBS	1
836	233804-36	TORX DRIVER	1
846	625415-00	PLUG	1
846	5140030-98	SHIM	1
856	DW4619	5X1/4 FASTCUT BK	1

COPYRIGHT© 2005. All Rights Reserved.

Parts list, pricing, and availability subject to change. Please visit [www.dewaltservicenet.com](http://www.dewaltservicenet.com) for current parts information.